

SPRING STAMPEX 16 FEB 2018



STOCKHOLMIA2019

29 MAY-2 JUNE

RECEPTION



WELCOME



- Fellows, Members and Guests to The Royal Philatelic Society London
- Patrons and Supporters to STOCKHOLMIA 2019
- Guests

Jonas Hällström RDP FRPSL

Exhibition Manager

STOCKHOLMIA2019
29 MAY - 2 JUNE

THE ROYAL

The Royal Philatelic Society London

Today the International Centre of Excellence for Philately



1869 - 2019

The Sesquicentennial Anniversary



STOCKHOLMIA2019

29 MAY-2 JUNE

**THE INTERNATIONAL CELEBRATION
OF THE 150TH ANNIVERSARY OF THE
ROYAL PHILATELIC SOCIETY LONDON**

PATRONS

The Society



Her Majesty The Queen
Elizabeth II

The Exhibition



H.M. King Carl XVI
Gustaf of Sweden

PATRONS & SUPPORTERS



Since Gustaf Douglas acquired one of the most famous stamps THE GOLDEN COLOR ERROR, 3 SKILLING BANCO YELLOW, he defines his collection as THE GOLDEN COLLECTION OF SWEDISH PHILATELY.

**I am Proud to be the Philatelic Head Patron
for the Society's Birthday Party in Stockholm**

PATRONS & SUPPORTERS



LEADERSHIP PATRONS	23
GOLD PATRONS	55
PATRONS	30
SUPPORTERS	19
TOTAL	127 → >175

Australia	1
Belgium	4
Denmark	1
France	2
Germany	12
Hong Kong	3
India	2
Italy	1
Luxemburg	1
Netherlands	1
New Zealand	1
South Africa	2
Sweden	37
Switzerland	7
United Kingdom	19
USA	32
Åland Islands	1
	127

www.stockholmla2019.se/PATRON/MEMBERSHIP

 [PayPal patron@stockholmla2019.se](mailto:patron@stockholmla2019.se)

PILOT PATRONS

The 150th Anniversary of The Royal Philatelic Society London

Venue



Gustaf Douglas

Frames



Erivan Haub

Exhibition Catalogues



Mitch & Alan Holyoake

Medal



Jan-Olof Ljungh

LEADERSHIP PATRONS

C.G.
Auctions

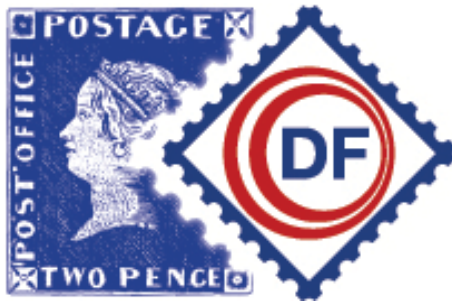

David Feldman
INTERNATIONAL AUCTIONEERS

VISION



The aim of **STOCKHOLMIA 2019** is to develop and improve the existing standards for philatelic events worldwide. **STOCKHOLMIA 2019** may in the future be recognised as a new milestone for competitive philately conducted through the exhibition format.

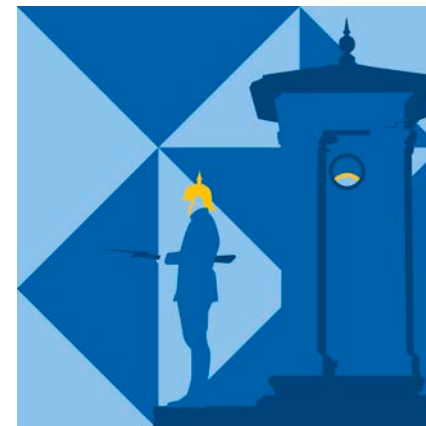

BULLETIN 1

Invitation to Display



APPLICATION



Official use by the exhibition only	
Application received	Application accepted
Exhibit No.	Frame No.
Bin-room at the exhibition <input type="checkbox"/> IN <input type="checkbox"/> OUT	Bin-room at the RPSL <input type="checkbox"/> IN <input type="checkbox"/> OUT

APPLICATION FORM (to World Philatelic Exhibition 2019 AB) FOR STOCKHOLMIA 2019

Mr./Mrs./Miss	Family name	Given name
Postal address		E-mail
		Telephone

Title of the exhibit
Short description of the exhibit

Exhibition class (for classes see IREX)	Competitive or non-competitive <input type="checkbox"/> Competitive <input type="checkbox"/> Non-Competitive	No. of frames applied for	Dimension of sheets Height Width
The best result achieved with the exhibit Name of the exhibition:	Level <input type="checkbox"/> F.I.P. <input type="checkbox"/> FEPA / FIAF / FIAP <input type="checkbox"/> National	Year	Result - points

The exhibit will be delivered (tick)		
<input type="checkbox"/> To the bin-room at the exhibition	<input type="checkbox"/> To the bin-room at the RPSL	<input type="checkbox"/> By the official carrier
The exhibit will be returned (tick)		
<input type="checkbox"/> From the bin-room at the exhibition	<input type="checkbox"/> From the bin-room at the RPSL	<input type="checkbox"/> By the official carrier
I would like to mount my exhibit (tick)	I plan to attend the exhibition in person (tick)	I plan to participate at the awards ceremony (tick)
<input type="checkbox"/> Yes <input type="checkbox"/> No	<input type="checkbox"/> Yes <input type="checkbox"/> No	<input type="checkbox"/> Yes <input type="checkbox"/> No

Insurance and Liability (see also IREX chapters 18 and 22)

I confirm that the material is submitted entirely at my own risk and undertake to make my own arrangements with regard to the insurance of the entry whilst it is out of my possession.

I confirm that all material in this entry is my bona fide property and that all information given is correct.

I agree that World Philatelic Exhibition 2019 AB, the organisers of Stockholm 2019 shall not be liable whether in contract, in tort, under any statute or otherwise for damage to or loss of my exhibit and for any loss consequential thereto including but not limited to loss of profit and loss of opportunity. Nothing in this declaration shall exclude or limit liability in respect of fraud or any statements made fraudulently.

I understand that it is my responsibility to obtain suitable insurance for the entire period that my exhibit will be held by World Philatelic Exhibition 2019 AB, the organisers of Stockholm 2019.

I note that it is a condition of acceptance of my exhibit that my insurer waives all rights of subrogation against World Philatelic Exhibition 2019 AB, the organisers of Stockholm 2019 and I confirm that it is a term of my insurance policy that there is such a waiver from my insurer or if there is no such waiver, I attach a waiver from my insurer of all its rights of subrogation against World Philatelic Exhibition 2019 AB, the organisers of Stockholm 2019.

I agree that the limitations on liability contained herein and in the IREX are reasonable in all circumstances at the date hereof and that World Philatelic Exhibition 2019 AB, the organisers, may assign any or all of their rights and/or obligations under this document.

I the undersigned (Exhibitor) hereby confirm that I have carefully read all the paragraphs in the IREX and I agree to accept the rules and regulations (IREX) relating to Stockholm 2019 including specifically the exclusion of the liability of the organisers contained therein.

Date _____ Signature _____

Mail this application form, together with the introductory title page, to:

Postal address: Stockholm 2019, Commissioner General, Box 55, SE-432 22 VARBERG, SWEDEN
E-mail address: commissioner@stockholmia2019.se

APRIL 2018

Sunday	Monday	Tuesday	Wednesday	Thursday	Friday	Saturday
1	2	3	4	5	6	7
8	9	10	11	12	13	14
15	16	17	18	19	20	21
22	23	24	25	26	27	28
29	30					

March 2018

S	M	T	W	Th	F	Sa
			1	2	3	
4	5	6	7	8	9	10
11	12	13	14	15	16	17
18	19	20	21	22	23	24
25	26	27	28	29	30	31

May 2018

S	M	T	W	Th	F	Sa
	1	2	3	4	5	
6	7	8	9	10	11	12
13	14	15	16	17	18	19
20	21	22	23	24	25	26
27	28	29	30	31		

Find more free calendars, planners, calculators and other templates on [Vertex42.com](http://www.vertex42.com)

Created using the Vertex42 Calendar Template for Excel

<http://www.vertex42.com/calendars/2018.html>

YOU ARE INVITED

STOCKHOLMIA 2019
20 MAY - 2 JUNE

FELLOWS AND MEMBERS - YOU ARE ALL INVITED

As the Society's Overseas Representative for the very active group of Swedish Fellows and Members, I was happy to take on the role of Commissioner General to STOCKHOLMIA 2019 - The International Celebration of the 150th Anniversary of The Royal Philatelic Society London.

**It is my great privilege as Commissioner General
to be able to invite you all as participants in this event.**

At STOCKHOLMIA 2019, the largest club exhibition ever organised, there will be possibilities for Fellows and Members of the Society to show their exhibits, either in competitive or non-competitive classes. There are no pre-qualifications required; membership of The Royal Philatelic Society London is the only requirement for participation.

The competitive classes will be judged by a highly qualified international jury and any result of the judging will qualify you for further exhibiting as from a British national exhibition under ABPS patronage. In the competitive classes you choose to participate with 1, 5, 6, 7 or 8 frames.

Not only as the Commissioner General, but also as a long-time collector myself, I know that many of us have collecting interests that are not suitable or possible to exhibit in the normal competitive classes. At STOCKHOLMIA 2019 there will be a large number of frames available for non-competitive exhibits and we specially invite those of you who have never exhibited before. In the non-competitive class you can choose from any number of frames between 1 and 8.



The Individual Regulations of the Exhibition (IREX) are presented in this bulletin.

I ask you to read them carefully as they give guidance on how to proceed with your application that must be received by the Commissioner General no later than 30th April 2018. If you have any questions before sending in your application, you are always welcome to contact me by email:

commissioner@stockholmia2019.se

I am looking forward to your application and hopefully to see you in Stockholm in 2019.

Jan Berg
Commissioner General

- ✓ 2,000 frames
- ✓ All (only) RPSL Members worldwide
- ✓ Non-Competitive Class
- ✓ Competitive Class
- ✓ Exhibit format: 1 or 5 to 8 frames
 - ✓ format optional
 - ✓ no pre-qualification required all RPSL members are qualified
 - ✓ selection by appointed committee
- ✓ International Jury



EXHIBITION MEDAL



The unique STOCKHOLMIA medal in classic format and style has two front faces, tracing the two countries' equal importance by depicting the world's most recognized stamps in stylized design.

Sebastian Schildt

CERTIFICATE



Patron Her Majesty The Queen

PRESIDENT

Patrick Maselis RDP

PAST PRESIDENTS

F. L. Walton.
Frank Walton RDP

B. Trotter.
Brian Trotter RDP

Chris Harman.
Christopher G Harman RDP

Gavin Fryer.
Gavin Fryer RDP

Alan K Huggins.
Alan K Huggins MBE RDP MSc PhD

Chris King.
Chris King RDP

Alan Moorcroft.
Alan Moorcroft RDP

David Beech.
David R Beech MBE

Jane Moubray.
Jane Moubray RDP

Patrick Pearson.
Patrick Pearson VRD RDP

STOCKHOLMIA2019
29 MAY - 2 JUNE

STOCKHOLMIA2019
29 MAY - 2 JUNE



THIS IS TO CERTIFY THAT
JONAS HÄLLSTRÖM

EXHIBITED THE COLLECTION
The Danish Caravel Postal Stationery
1927-1952

AWARDED
GOLD

IN CLASS
Postal Stationery Class

EXHIBITION MANAGER

PRESIDENT OF THE JURY

STOCKHOLM 1 JUNE 2019

PHILATELIC PARTNER



The Global Philatelic Network

Sell your stamps where your stamps sell best

PHILATELIC PARTNER

1. Financial Commitment
2. Work Commitment
 - Management Team
 - Company Staff
3. Extensive Marketing
4. Networking
5. Activities at STOCKHOLMIA 2019

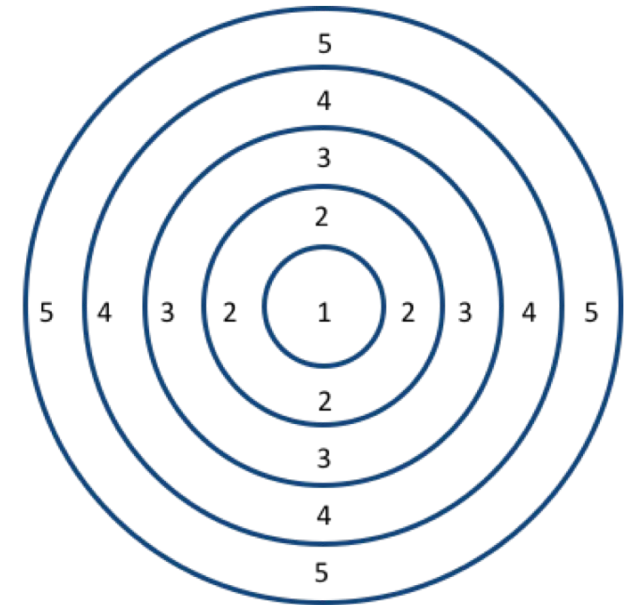

6. GRAND AWARD



H.R. HARMER
EST. 1940
FINE STAMP AUCTIONS



HEINRICH KÖHLER
Germany's Oldest Stamp Auction House



JOHN BULL
AUCTIONS, SINCE 1977
布約翰拍賣

7. RARITY AUCTION

150 candles on a birthday cake?

There's an easier way to give the Royal a birthday present ...



H.R. HARMER
EST. 1940
FINE STAMP AUCTIONS



HEINRICH KÖHLER
Deutschlands ältestes Briefmarken-Auktionshaus



JOHN BULL
AUCTIONS, SINCE 1977
布約翰拍賣

7. RARITY AUCTION

Total Hammer price	Standard fee	Your reduced STOCKHOLMIA 2019 Rarity Auction flat rate* ¹ consignment fee* ²	Therefrom WE donate to The Royal Philatelic Society London
Above € 100,000 / £ 90,000	15%	5%	5%
€ 50,000 - € 100,000 / £ 45,000 - 90,000	17,5%	10%	5%
€ 20,000 - € 50,000 / £ 18,000 - 45,000	20%	12,5%	5%
Below € 20,000 / £ 18,000	22,5%	15%	5%

*¹ Including insurance, lot fee, etc.

*² Plus then valid VAT (on commission only).



7. RARITY AUCTION

☐ Maximum attention guaranteed!

- Thousands of high potential collectors worldwide, who receive the printed catalogue
- Hundreds of thousands high potential collectors worldwide, who have access to the online catalogue through our websites and most important auction platforms
- The most important collectors (potential buyers) from all over the world will meet at STOCKHOLMIA 2019
- The auction room at Stockholm Waterfront Congress Centre will seat 1,000+ bidders.

☐ Add-on for consignments €50,000+ / £45,000+

☐ Your collection published in a book



WELCOME TO OUR STAND



H.R. HARMER
EST · 1940
FINE STAMP AUCTIONS



JOHN BULL
AUCTIONS, SINCE 1977
布約翰拍賣

STOCKHOLMIA 2019

STOCKHOLM WATERFRONT CONGRESS CENTRE



LOCATION

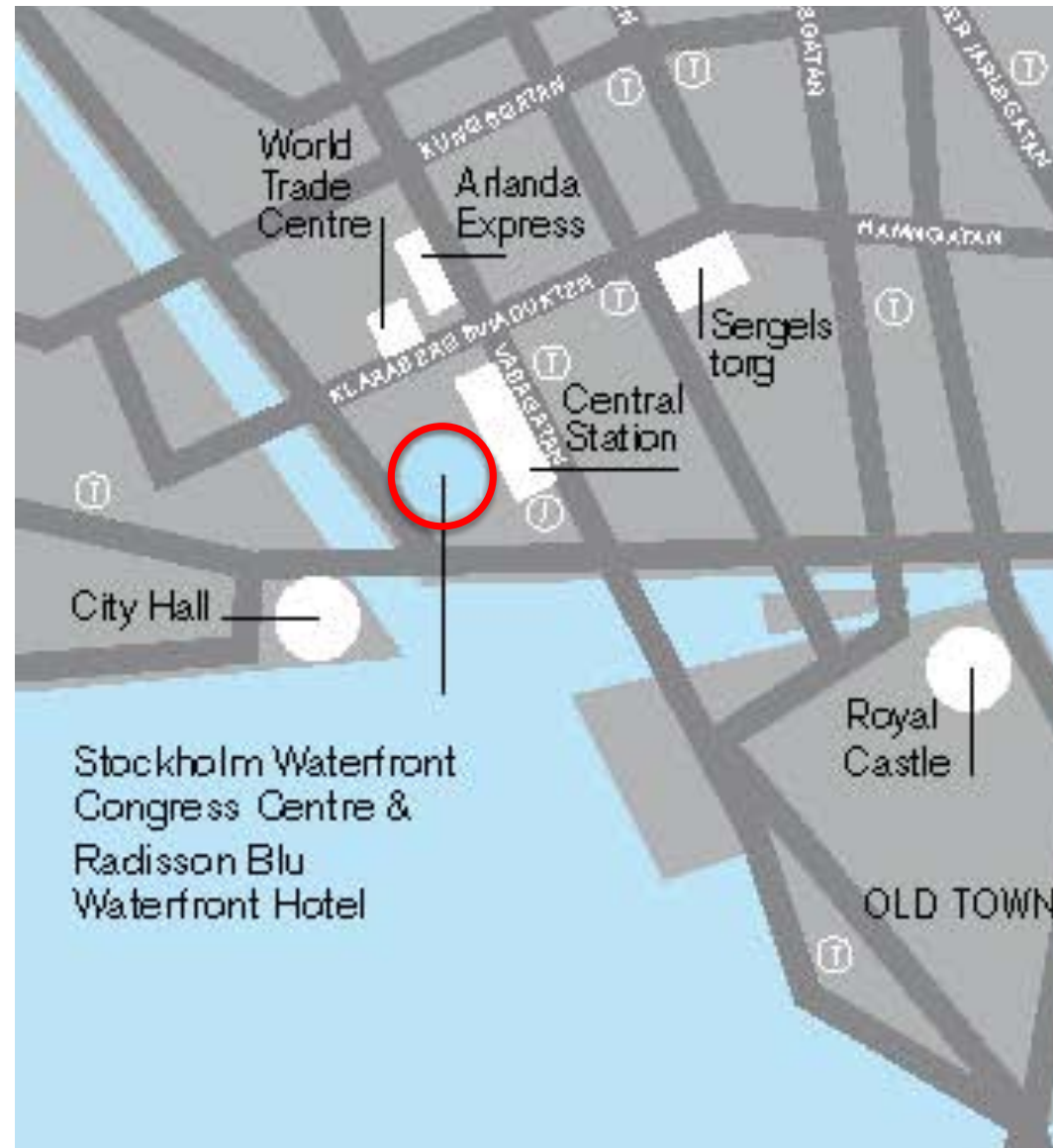

COMPREHENSIVE PHILATELIC PROGRAM

Opening hours

28-5	Tuesday	3.00-7.00 p.m. Vernissage for Exhibitors, Dealers and Invited Guests
29-5	Wednesday	10.00 a.m. to 6.00 p.m. Open to the public
30-5	Thursday	10.00 a.m. to 6.00 p.m. Open to the public
31-5	Friday	10.00 a.m. to 6.00 p.m. Open to the public
1-6	Saturday	10.00 a.m. to 5.00 p.m. Open to the public
2-6	Sunday	10.00 a.m. to 3.00 p.m. Open to the public

- ✓ Auditorium 1,500 seats
 - ✓ Opening Ceremony
 - ✓ Daily RPSL Meeting conducted as a 3 p.m. Presentation
 - ✓ Rarity Auction
- ✓ 15 Meeting Rooms
 - ✓ Philatelic Congress of Great Britain
 - ✓ Cinderella Congress
 - ✓ Literature Releases
 - ✓ Society Meetings
 - ✓ Presentations
- ✓ RDP Ceremony
- ✓ AIJP Congress
- ✓ AEP Meeting

... to be developed

LEVEL 4



STAND HOLDER TEAM

Country	
Australia	1
Canada	1
Denmark	3
Finland	2
Germany	5
Hong Kong	1
Netherlands	1
Norway	1
Poland	1
Sweden	13
Switzerland	3
Thailand	1
United Kingdom	13
United States of America	5
	51



- Patronage
- AGM

Ifsda Trade Liason Officer
Lars-Olow Carlsson
VP ifsda



LEVEL 5

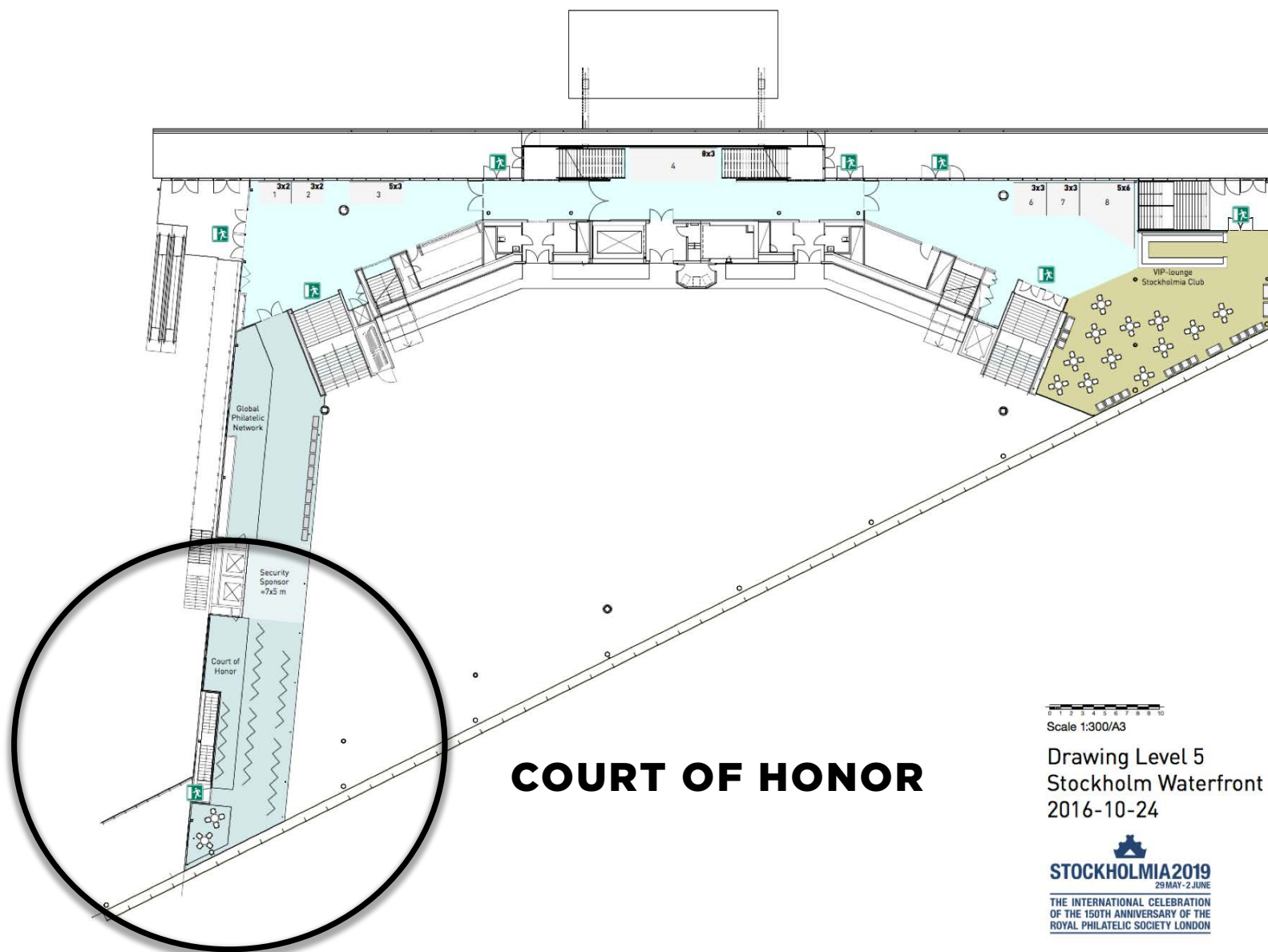

COURT OF HONOR

Scale 1:300/A3

Drawing Level 5
Stockholm Waterfront Congress
2016-10-24

STOCKHOLMIA2019
29 MAY - 2 JUNE
THE INTERNATIONAL CELEBRATION
OF THE 150TH ANNIVERSARY OF THE
ROYAL PHILATELIC SOCIETY LONDON

COURT OF HONOR THE SOCIETY'S PATRON



Patron Her Majesty The Queen



COURT OF HONOR



**THE GOLDEN COLLECTION
OF SWEDISH PHILATELY**

COURT OF HONOR



SELECTED

RPSL PUBLICATIONS
CRAWFORD WINNERS



Tomas Bjäringer
RDP Hon. FRPSL

COURT OF HONOR

STOCKHOLMIA2019
29 MAY - 2 JUNE



Kings and Queens in Philately

1. Who are the Collectors?

- In the past, most members of Royalty received proofs and stamps with their effigy from their relevant postal authorities. The list of members of Royalty would be far too long to list ...
- The King, Queen or Prince must have been personally involved in searching for specific items for his or her collection or in one way or another have promoted the Royal collection inherited or improved from another member of the family.

Even with this restriction, the list is not at all short ...

COURT OF HONOR

2. Some Names

King
ALPHONSO XIII
of Spain

King
CAROL II
of Romania

From left to right :
Théodore Champion, King
Carol and Sir John Wilson



King
FAROUK I
of Egypt



Sultan
FUAD of Egypt,
later King FUAD

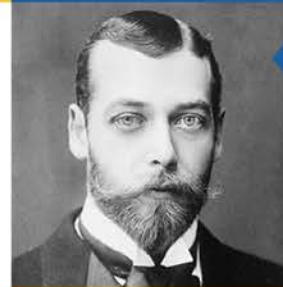

King
GEORGE V

King
GEORGE VI

King
HUSSEIN
of Jordan

Prince
KARL EGON III
of Furstenberg



King
LEOPOLD III
King of the
Belgians and
his son, the future
King Baudouin



Princess
Maha Chakri
SIRINDHORN

Prince
Alphonso
DORIA-
PAMPILI

Prince
GUSTAV
ADOLPH
of Sweden

Prince
RAINIER III
of Monaco

LEVEL 3

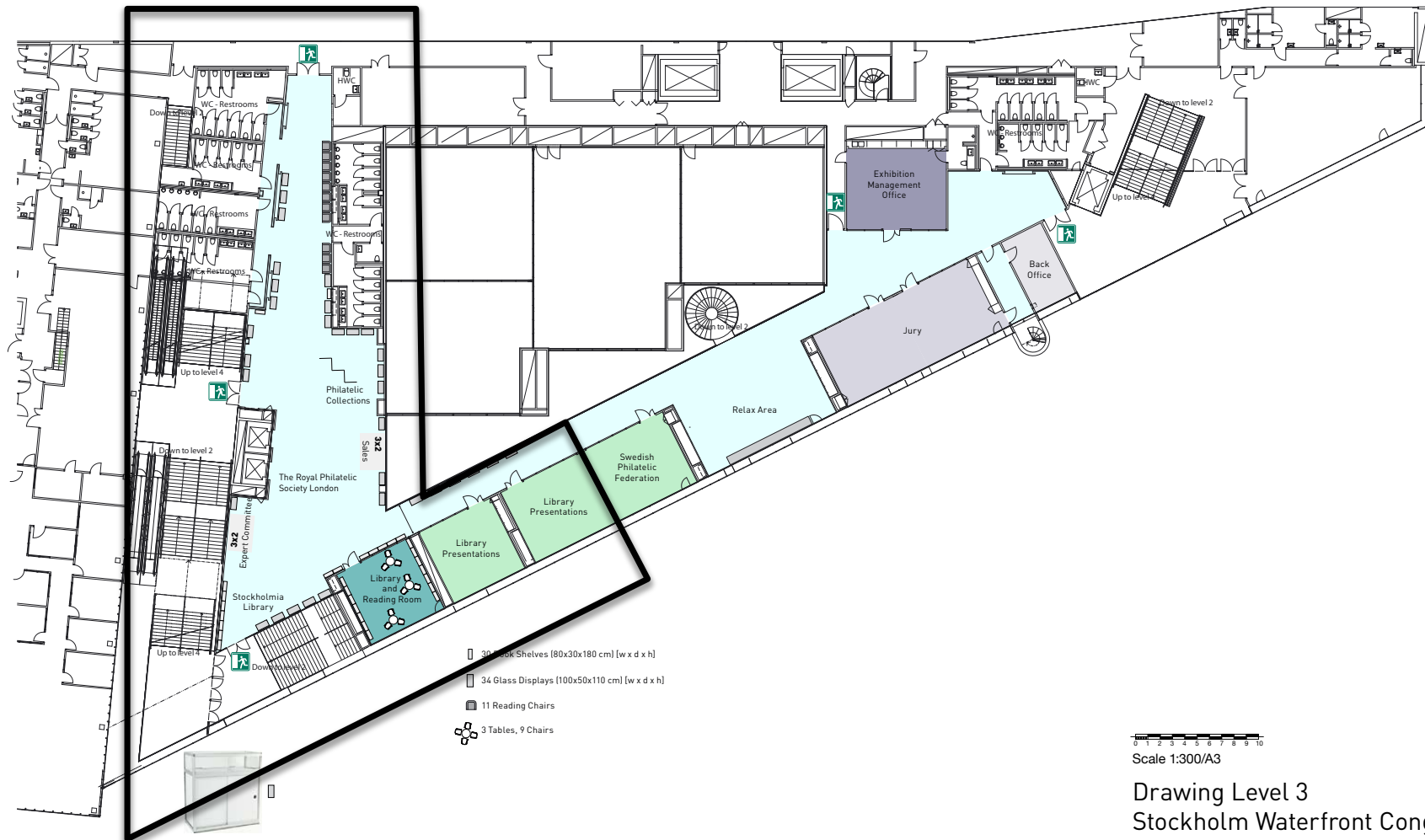

STOCKHOLMIA LIBRARY

Drawing Level 3
Stockholm Waterfront Congress
2017-10-25

STOCKHOLMIA2019
29 MAY - 2 JUNE
THE INTERNATIONAL CELEBRATION
OF THE 150TH ANNIVERSARY OF THE
ROYAL PHILATELIC SOCIETY LONDON

LEVEL 2

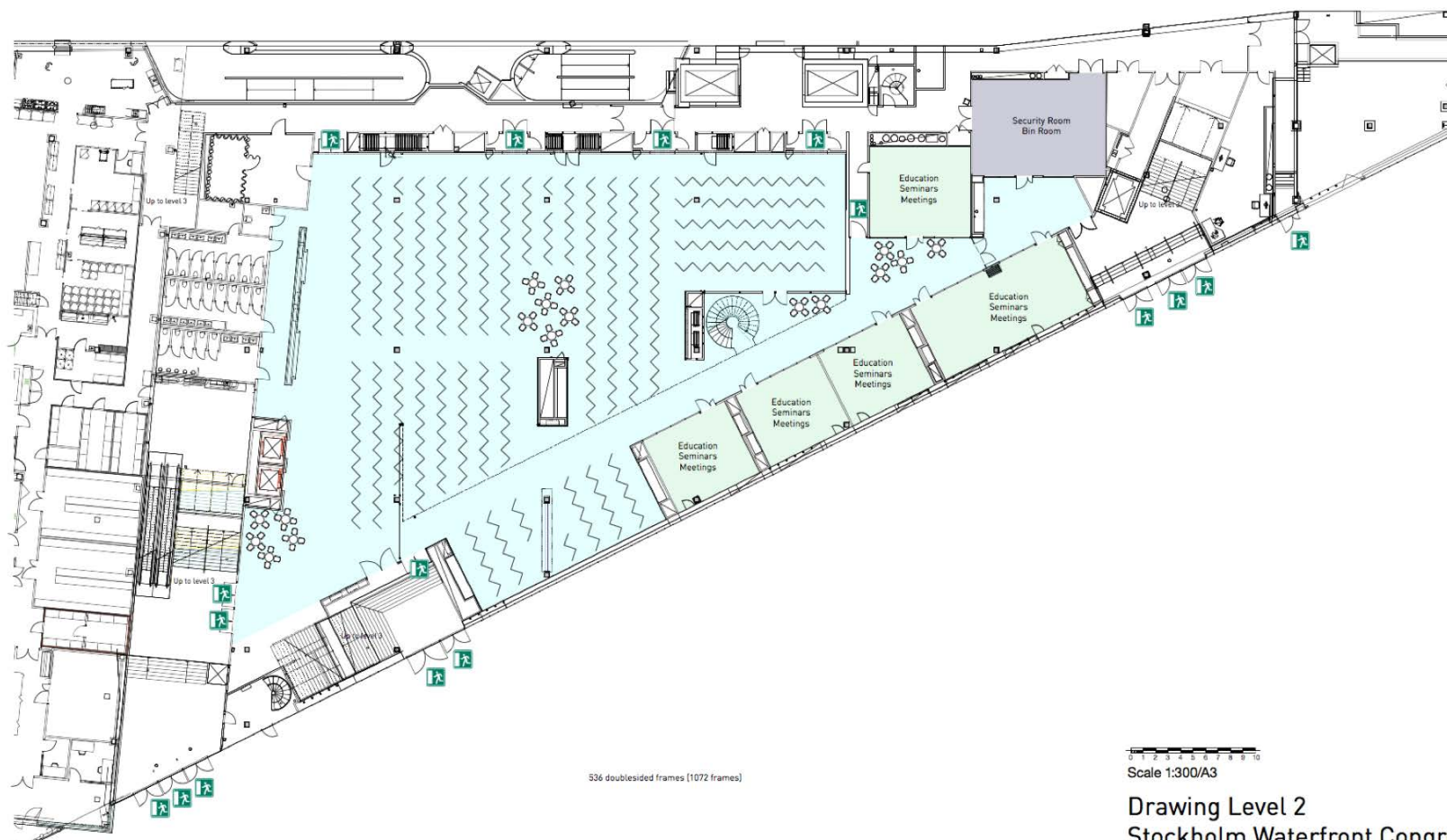

Scale 1:300/A3

Drawing Level 2
Stockholm Waterfront Congress
2016-08-23

STOCKHOLMIA2019
29 MAY - 2 JUNE
THE INTERNATIONAL CELEBRATION
OF THE 150TH ANNIVERSARY OF THE
ROYAL PHILATELIC SOCIETY LONDON

STOCKHOLMIA LIBRARY

- AIJP Patronage
- Managed by Wolfgang Maassen
- Selection from BJÄRINGER LIBRARY (Court of Honor)
 - RPSL Publications
 - Crawford Winners
- Reading Room
 - Stockholmia Literature Class
- Two Library presentations Rooms
 - Full time program from 11.00 to 17.30 each day
 - Educational subjects aiming authors and publishers
 - Lectures about early philatelic literature in different countries
 - Capacity for 8 book presentation each day



Wolfgang Maassen RDP FRPSL
Philatelic Literature Authority and Bibliophile
AIJP President



STOCKHOLMIA CATALOGUES



Release date 11 April 2019 in London at the
"Past Presidents Display" at the RPSL

Wolfgang Maassen RDP FRPSL

Philatelic Literature Authority and Bibliophile
AIJP President

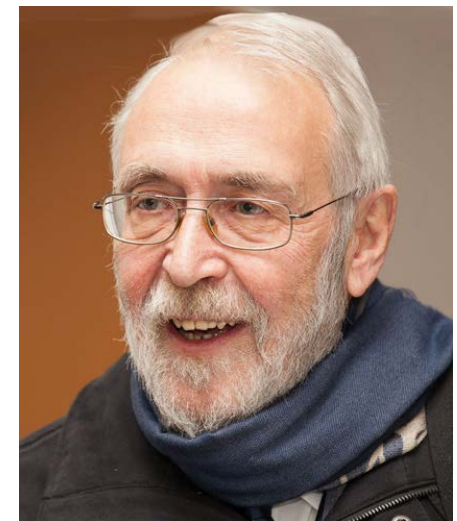

STOCKHOLMIA LIBRARY CATALOGUE

- ❑ **RPSL Publications**
 - Each book presented, with different photos and a short description
- ❑ **Crawford Winners**
 - Each book will be presented, a few books on one or two pages, with different photos and a short description
- ❑ **STOCKHOLMIA 2019 Literature Display Entries**
 - Court of Honour Library books by Tomas Bjäringer: 20 glass cabinets (show cases) and each one is good for up to six items
- ❑ **STOCKHOLMIA 2019 Literature Competitive Entries**
 - Each entry presented with the bibliographical data (and adress where to buy)

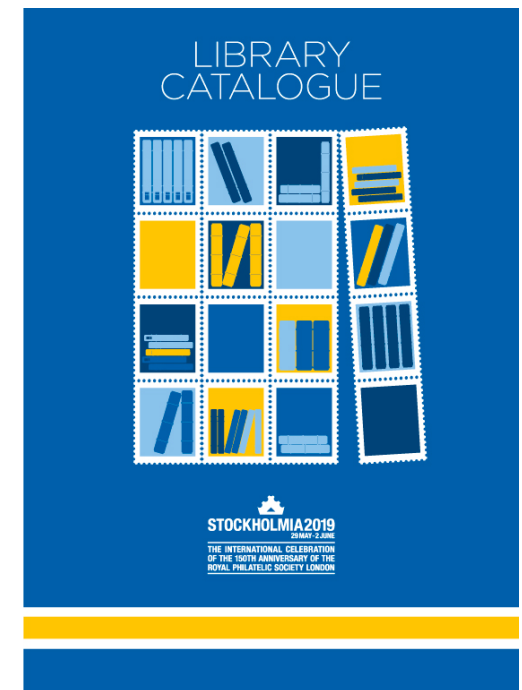

ca 300 Pages

KEY ARTICLE

Mårten Sundberg Prepares Article about the Society for the STOCKHOLMIA 2019 Exhibition Catalogue



The scope for that article will be to reflect the Society's current everyday life. More precisely: In fifty years' time, when we will have our 200th anniversary, a reader of this article should be able to understand how the everyday of the Society was performed fifty years ago (2019)

LONDON PHILATELIST

LP Editor

Two Extra Editions

Second day
30 May

Last day
2 June

❑ Editions 2,500



Seija-Riitta Laakso
Mårten Sundberg
Christer Brunström

STOCKHOLMIA
Photographer



Dane Garrod

AFTER ACTION REVIEW

London Philatelist Supplement

AAR

□ September 2019

LP Editor



Seija-Riitta Laakso
Mårten Sundberg
Christer Brunström

STOCKHOLMIA
Photographer

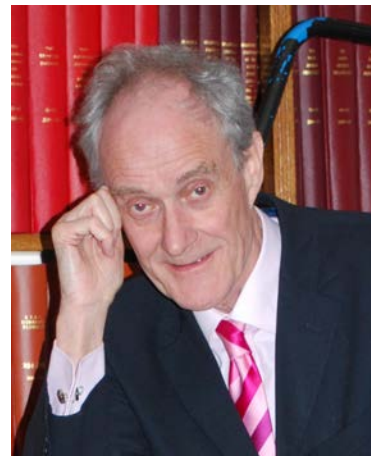

Dane Garrod



SOCIAL PROGRAM



- 28 May VERNISSAGE 3.00-7.00 p.m.
- 29 May OPENING CEREMONY
- 29 May STOCKHOLMIA CLUB DINNER
- 30 May STOCKHOLMIA WELCOME RECEPTION
- 31 May EXCURSION
- 31 May RDP CEREMONY
- 1 June STOCKHOLMIA BANQUET

SOCIAL PROGRAM





REGISTRATION

<https://www.delegia.com/stockholmia2019/MembersRPSL>

DESTINATION MANAGEMENT

www.meetagain-stockholmia2019.se



STOCKHOLMIA 2019
29 MAY - 2 JUNE

HOME

STOCKHOLM INFO

MEETAGAIN SERVICES

REGISTRATION & TICKETS

CONTACT



ONLINE BOOKING



Welcome to Stockholm

Meetagain is the local partner for Stockholmia 2019 (29 May - 2 June) in Stockholm, Sweden. We are happy to help you with destination packages, accommodation, tickets and other local arrangements for the 10 000 visitors and stakeholders expected to visit Stockholm during the exhibition week.



Travel



Star Alliance member airlines are the Official Airline Network for Stockholmia 2019. Save up to 20% on travel with the Star Alliance™ Network.

>>

Hotels



Tree Hotel, Hårads Photo: Lola Akinmade Åkerström sweden.se

We offer hotels ranging from 5* level to 3* economy level. We manage both individual and group bookings.

>>

Airport Transfer



Stockholm's airports are connected to downtown by airport coaches as well as municipal alternatives. From Stockholm Arlanda-Airport you can also choose the high-speed train service Arlanda Express.

>>

Sightseeing Tours

Special Offers

HANDOUT #3



Presented to Fellows, Members and Guests
attending the reception hosted by The Global Philatelic Network

THE STOCKHOLMIA RECEPTION



16 February, 12.00 a.m. in London, at the Executive Centre at
Business Design Centre, Islington on the occasion of Spring Stampex 2018

Great Britain and Sweden
Early Mail and Mail Connections

HANDOUT #3

Sweden and Great Britain Mail Connections Till U.P.U.

Wayne Donaldson

In this overview of the evolution of mail services between these nations the reader will immediately realise how changes in the delivery of mail closely paralleled what was happening in the other country. As for mail between them, there were relatively few occasions when ships travelling from Gothenburg and English east coast ports carried mail directly between the two countries. Consequently postage rates had to account for other nations' transit fees. Rates were linked to routes through the Netherlands and later Belgium and the north German states but rarely via France. At most times mail went via Hamburg until 1853 British letters were carried there mostly on British ships, often packet ships. At different times letters were sent over Denmark or via Lübeck or the Prussian ports of Greifswald, Stralsund or Stettin to Ystad and later to Malmö.

The Earliest Mails by Courier

Throughout history a postal system was the realm of royalty and political administration for rulers need to be able to receive information quickly from and to send instructions to the far corners of their domain. English monarchs since at least the Hundred Years' War have had couriers who, from the reign of Charles II, were known as King's Messengers (in 2017 sixteen Queen's Messengers work in the Foreign and Commonwealth Office to carry classified material to missions). Swedish kings employed similar couriers known as Ensigns.

In 1561, Sweden's King Eric XIV sent a courier with the letter he wrote diplomatically in Latin to his "Dearest cousin" Queen Elizabeth I apologising that severe westerly winds were preventing his ship leaving Sweden for he had hoped to come to meet her so that she could see what a fine husband he would make if she were to accept his intended marriage proposal (there is no record he ever again attempted the voyage or offered her his hand in marriage). A copy of this letter is drawn below his handsome figure to illustrate improvements in communications that had occurred over the years since in one of a mini-sheet of four Swedish postage stamps engraved by Czechoslovakia that were issued in 1984 to publicise the forthcoming STOCKHOLMIA 1986 philatelic exhibition. (FIGURE 1).

King Eric wrote another letter to Queen Elisabeth in 1563 seeking to forge closer links with England. In the letter the king asked for permission to recruit mercenaries.

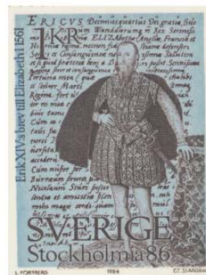

FIGURE 1. King Eric XIV's letter to Elisabeth I.



7

Great Britain → Sweden A Selection From The Golden Collection of Swedish Philately

Gustaf Douglas FRPSL

1853 from GREAT BRITAIN
1 shilling 2 pence Multiple Postage
1854-58 Queen Victoria Postmarked

First Folded Prepaid Letter Mail rate from DEAL 9.5.1853
via Dover-Ostende-Hamburg-Berlin to Stockholm



The total single rate of 1s 2d is composed as
UK
Sweden
Danish transit
Total rate paid

6d
4d One from the UK
4 d Due from the UK
1s 2d
Current

From Sweden the prepaid single letter mail rate was lowered to 1 shilling 2d from September 1855.
The Swedish rate was lowered to 10 skilling from 1 December 1855. Just the British rate remained unchanged in the next two years until 11 1855.



27

Sweden → Great Britain The 36 Skilling Letter Rate 1855 to 1858

Tomas Bjäringer RDP Hon. FRPSL & Jonas Hållström RDP FRPSL

Context

Mail to foreign destinations with the first Swedish adhesives of skilling banco denominations is sought after by collectors of Swedish postal history. Sweden was one of the first countries where philatelists started to collect postal history, that is rates, routes and destinations. The Postal Museum in Stockholm has a large collection of postal history that was gifted by Harald Sundstedt (1879-1935) in 1934. Lars Hedberg (1894-1967) was another pioneer and great collector of Swedish postal history. By the 1960s, many Swedish collectors began to study postal history, where rates, routes and destinations were the main focus. Sigurd Ringström RDP (1908-1992), Per Sjöman (1905-1974) and Sven Åkerstedt (1904-1977) were leaders in this movement toward postal rates.



FIGURES 41-43. Sigurd Ringström, Per Sjöman and Sven Åkerstedt were three pioneers developing postal history in Sweden.

At the international exhibition 1974 in Stockholm, Tomas Bjäringer (b.1946), Gustaf Douglas (b.1938) and Sven Sundstedt (1921-2016) wrote an article published in the exhibition catalogue titled "Swedish Postal Articles during the Skilling Period July 1, 1855 - June 30, 1858". The article was published in four languages. The article showed how many stamped postal items were handled during the first three years of Swedish postage stamps and how many stamped skilling covers there were to foreign destinations.

The volume of mail during the Skillingperiod was 6.6 million pieces, of which 200,000 were sent to foreign destinations. Based on the article from 1974, a few enthusiastic collectors have continued indefatigably to gather additional and new information about Sweden's first issues used on mail. Gunnar Nilsson (b. 1928) and Tomas Bjäringer are in progress with a comprehensive study of Swedish domestic mail including first and second-rate mail and mail to foreign destinations from the first three years 1855 to 1858.



33

Are You Getting Prepared yet for STOCKHOLMIA 2019?

Exhibiting or Visiting?

STOCKHOLMIA 2019
29 MAY - 2 JUNE

THE INTERNATIONAL CELEBRATION
OF THE 150TH ANNIVERSARY OF THE
ROYAL PHILATELIC SOCIETY LONDON

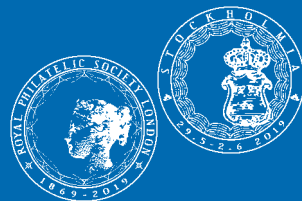

**STOCKHOLMIA 2019 will be
an international philatelic
exhibition, with 2,000 frames
in the Competitive Classes or
Non-Competitive Display Class**

**Bulletin 1 is presented and is
available online**

**Your visit is prepared
together with a comprehensive
Destination Package**

**Book your TRAVEL and VISIT
online**

**50+ Trade Stand Holders
from the whole world**

WWW.STOCKHOLMIA2019.SE

